

Attachment C

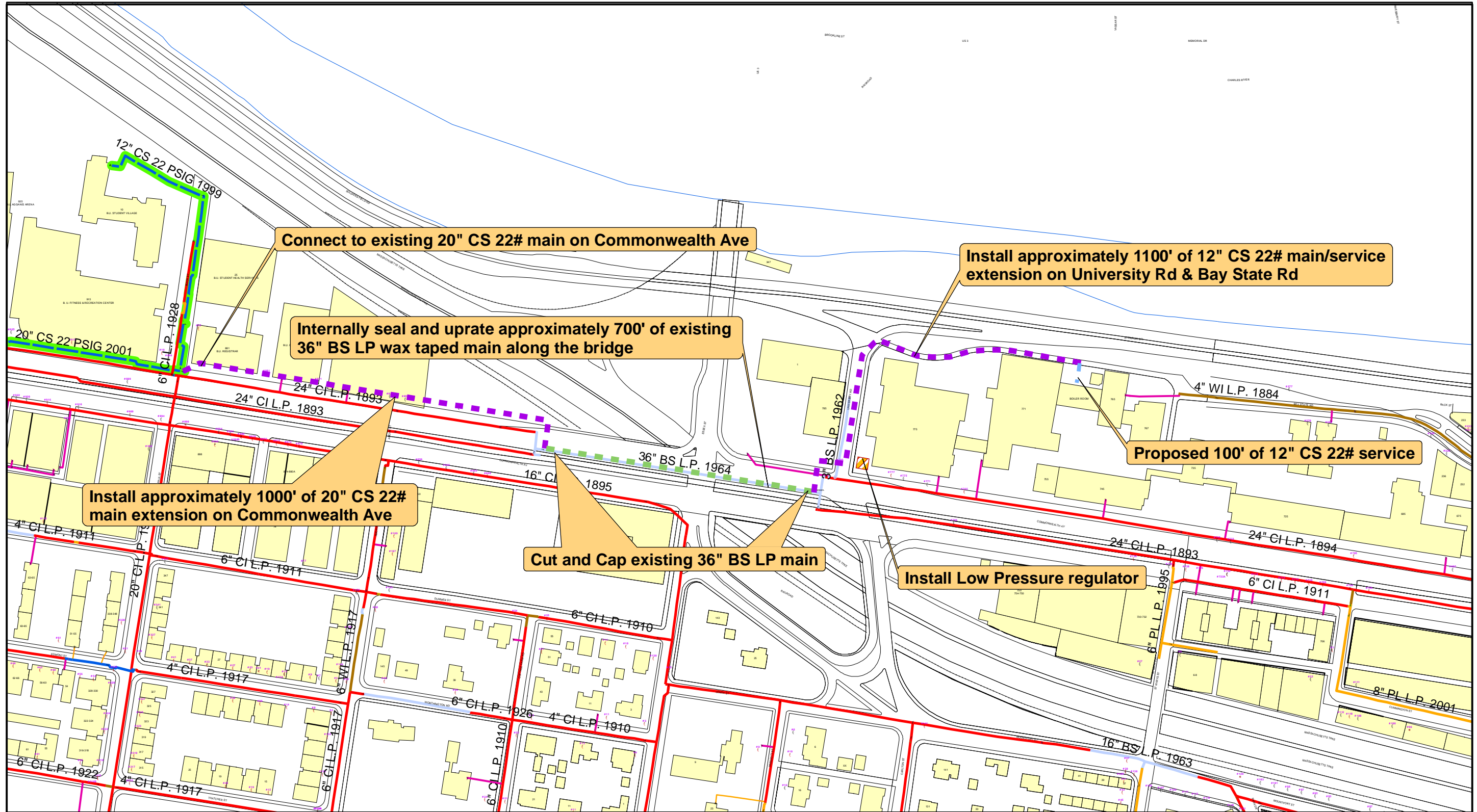

ENGINEERING DESIGN - Proposed Scope of Work

763 Commonwealth Ave, Boston University East Campus - 22# Main Extension

Install 20" & 12" CS 22# main from Commonwealth Ave @ Buick St to the BU East Campus:

- 1.) Install 1,100' of 20" CS 22# main on Commonwealth Ave
- 2.) Internally seal and uprate approximately 700' of 36" BS main on bridge
- 3.) Install 400' of 12" CS 22# main on University Rd
- 4.) Install 700' of 12" CS 22# main on Bay State Rd

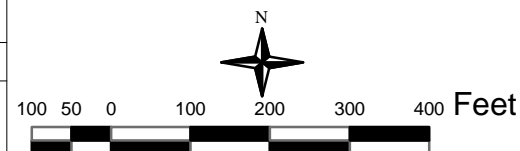

NOTE: The location of surface and underground objects shown are not warranted to be correct.

ENGINEER	AJD	SIZE	20" / 12"
DATE	09/29/2009	MATERIAL	CS
LENGTH	1100' / 1200'	PRESSURE	22 PSIG
SECTIONALS	83793	WORK ORDER #	El: 2330687
	83794		
	83795		

ArcFM

nationalgrid